



# LSR CONSTITUTION

D 62 EN Ind.D

11/10/2023

The Non-Rotational Mechanical Splice (LSR) consist of a standard LS thread, an LSR clearance thread, and a standard coupler fully screwed onto the 2nd phase bar.

This splice allows the coonection of a threaded 1st phase bar, wheter previously embedded in concrete or not, with a long, straight thread 2nd phase bar that is difficult to rotate.

1st phase thread

## LS

With RFI reservation  
Check C range thread length sheet  
PC 26

Standard thread LS

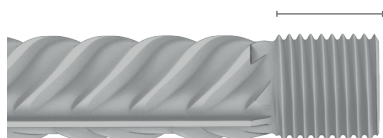

## COUPLER

C / PI / DYN range

technical sheet D27 / D33 / D35

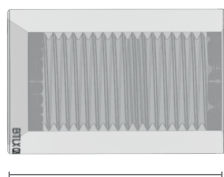

C / PI / DYN coupler

2nd phase thread

## LSR

With LSR thread  
Check C range long clearance threads sheet  
PC 27

Long thread LSR

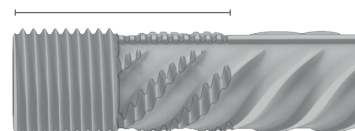

		1st phase thread LSR	Standard coupler	2nd phase thread LSR
Ø Rebar	Name	Thread	Coupler	Thread
Ø12	LSR 12	LS 12	C 12   PI 12	LSR 12
Ø14	LSR 14	LS 14	C 14   PI 14   DYN 14	LSR 14
Ø16	LSR 16	LS 16	C16   PI 16   DYN 16	LSR 16
Ø20	LSR 20	LS 20	PI 20   DYN 20	LSR 20
Ø25	LSR 26	LS 25	C 26   PI 26   DYN 26	LSR 25
Ø40	LSR 32	LS 32	C 32   PI 32   DYN 32	LSR 32
Ø40	LSR 40	LS 40	C 40   PI 40   DYN 40	LSR 40

For installation instructions, look for PT03